

Lunar - UK sockets

Manual circuit breaker reset

(appropriate tool required to reset)

Type-A and C USB charging

Keystone blank

Lunar - Schuko sockets

Contents

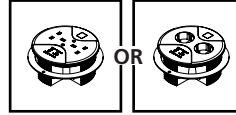

Dimensions

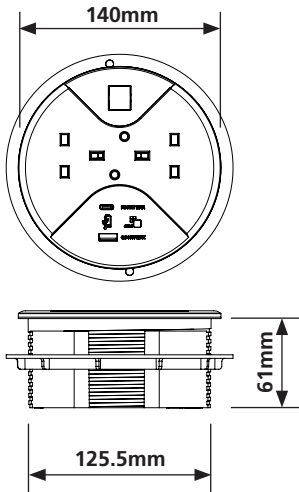

Connecting data/AV

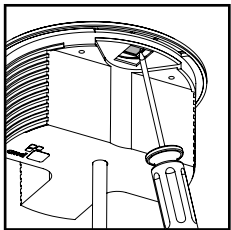

With the fixing nut removed, depress the clip on the keystone blank to release it.

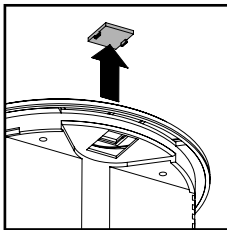

Remove the keystone blank and keep it in a safe location for future use.

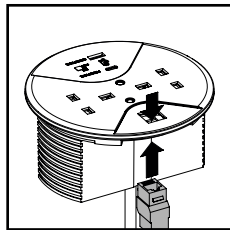

Insert a data keystone coupler from the underside (coupler supplied separately).

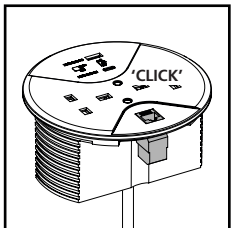

The keystone coupler should click into place if installed correctly.

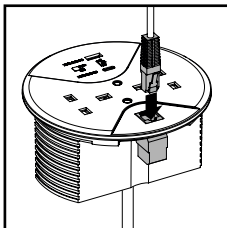

Insert desired/relevant data cables into the keystone coupler.

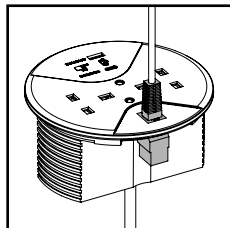

The cable connector should fit securely in place.

Mounting to desk

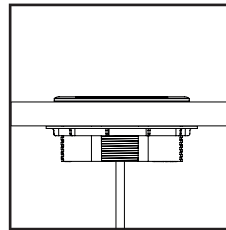

Ensure there is sufficient space under the desk to accommodate the Lunar body and nut.

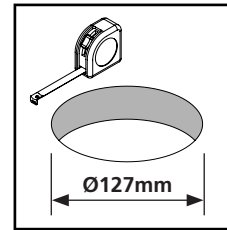

Carefully measure and cut out the aperture in the desk surface if not already present.

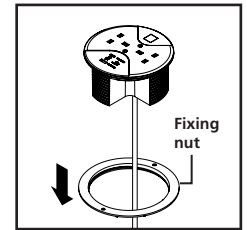

Unscrew the fixing nut from the Lunar body to allow it to pass through the aperture.

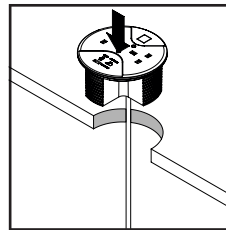

Ensure the aperture in the desk is free of debris then carefully lower the Lunar into place.

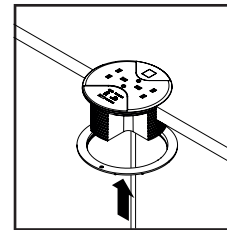

Feed the cable through the fixing nut ready for the Lunar to be fixed in place.

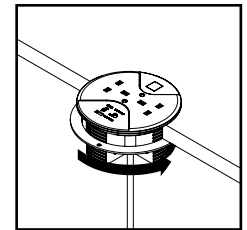

Ensure the sockets are in the desired orientation and secure in place by tightening fixing nut.

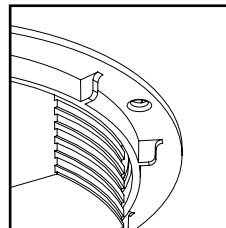

The fixing nut has 2x fixing holes to allow it to be screwed to the underside of the desk.

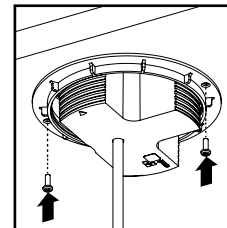

If required, use 2x appropriate fixings when the fixing nut is fully tightened to the desk.

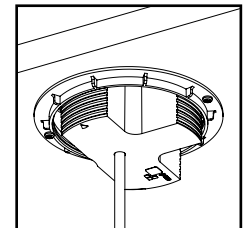

Ensure not to overtighten the fixings against the fixing nut (screws not supplied).

Connecting to power

Connecting standard 3-pole connector

****WARNING****
The input connector must not be engaged or disengaged when under load or live.

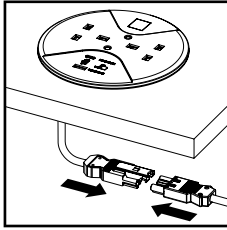

Plug the male 3-pole connector supplied as standard into a female powered connector.

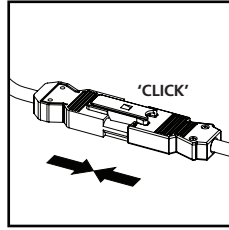

Ensure the attached locking mechanism clicks into place on both connectors.

Note the starter lead is not supplied and is sold separately.

Disconnecting standard 3-pole connector

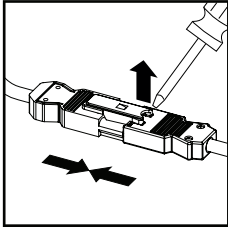

Use an appropriate tool to release the locking mechanism.

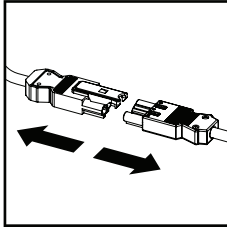

Separate the connectors.

USB charging

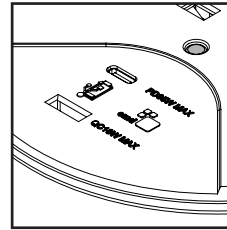

Lunar is fitted with integral USB type-A (18W max) and type-C (65W max) chargers.

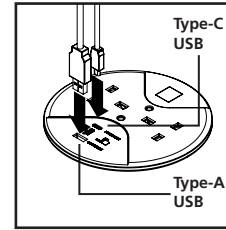

Insert type-A and type-C USB cables into their respective ports as shown.

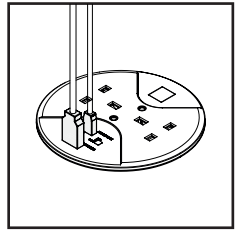

Ensure cables are securely connected.

Resetting the circuit breaker (UK socket version only)

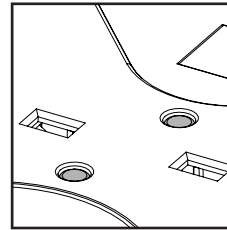

Lunar is fitted with an integral circuit breaker for each socket.

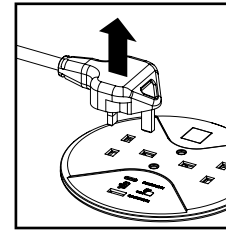

In the event of the circuit breaker tripping, remove the connected plug first.

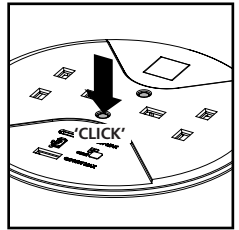

Using an appropriate tool, fully depress the reset button until a click is heard.

Additional information

Safety

- Installation is to be carried out in accordance with relevant Health & Safety regulations and only to be carried out by a skilled or competent person.
- The product should be installed to comply with the relevant national standards and be inspected and tested prior to being put into service (in the UK BS 7671 Wiring Regulations or BS 6396 Office and Educational Systems Best Practice).
- Isolate the supply before installation or repositioning. Any locking mechanisms must be used and fully engaged.
- Incorrect use could lead to risk of electrocution.
- Connectors must not be engaged or disengaged when under load or live.
- Product to be used only for the intended purpose of distributing power and data in office and commercial environments.
- Do not misuse, dismantle or re-configure the product because doing so will invalidate the warranty.

Standards

- Refer to the Declaration of Conformity.

Further guidance

- Should the supply cable need replacing, contact CMD.

Product care

- Clean using a dry cloth. No abrasives or solvents to be used on the product.
- Do not drop or expose to moisture.

