

## Dimensions

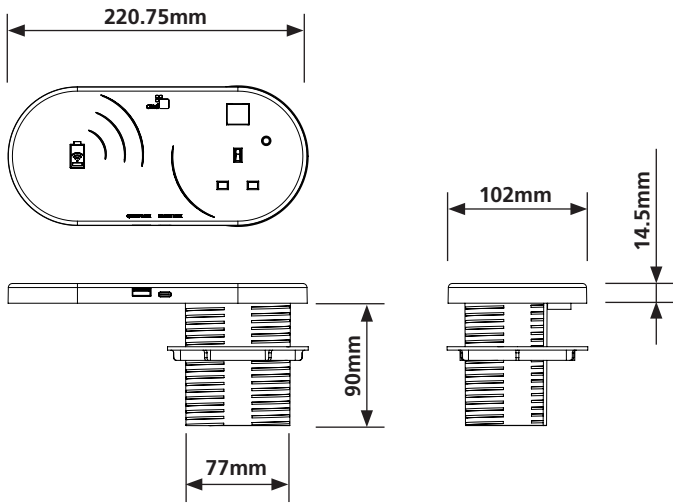

## Connecting data/AV

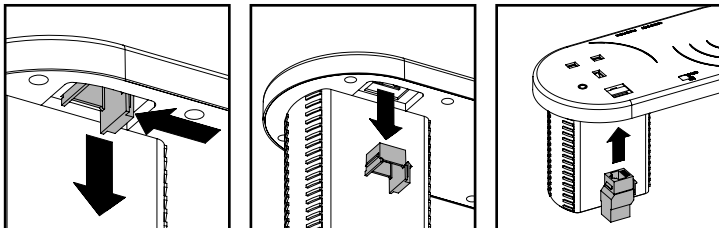

With the fixing nut removed, depress the clip on the keystone blank to release it.

Remove the keystone blank and keep it in a safe location for future use.

Insert a data keystone coupler from the underside (coupler supplied separately).

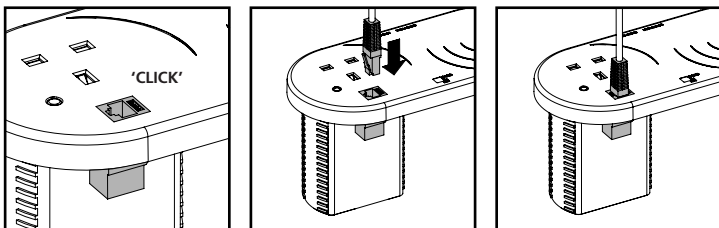

The keystone coupler should click into place if installed correctly.

Insert desired/relevant data cables into the keystone coupler.

The cable connector should fit securely in place.

## Contents

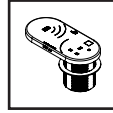

## Mounting to desk

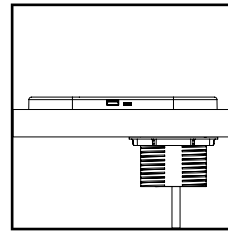

Ensure there is sufficient space under the desk to accommodate the Neptune body and nut.

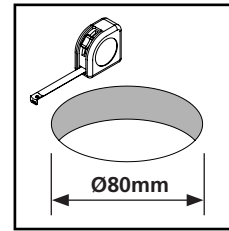

Carefully measure and cut out the aperture in the desk surface if not already present.

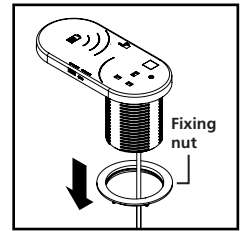

Unscrew the fixing nut from the Neptune body to allow it to pass through the aperture.

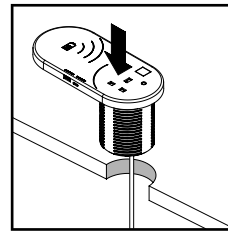

Ensure the aperture in the desk is free of debris then carefully lower the Neptune into place.

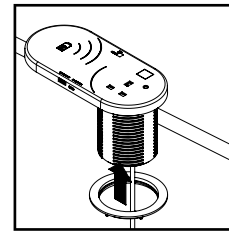

Feed the cable through the fixing nut ready for the Neptune to be fixed in place.

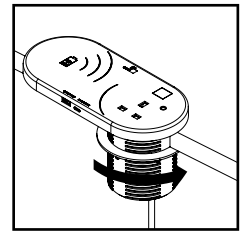

Ensure the socket is in the desired orientation and secure in place by tightening fixing nut.

## Connecting to power

### Connecting standard 3-pole connector

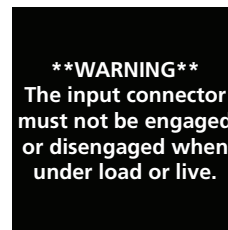

Note the starter lead is not supplied and is sold separately.

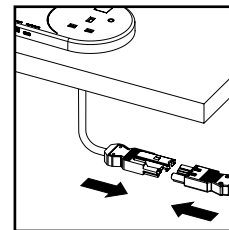

Plug the male 3-pole connector supplied as standard into a female powered connector.

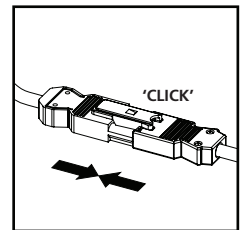

Ensure the attached locking mechanism clicks into place on both connectors.

### Disconnecting standard 3-pole connector

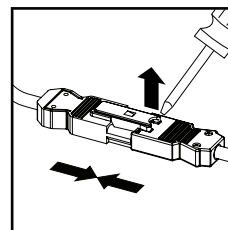

Use an appropriate tool to release the locking mechanism.

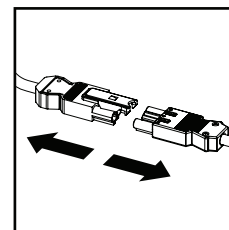

Separate the connectors.

## USB charging

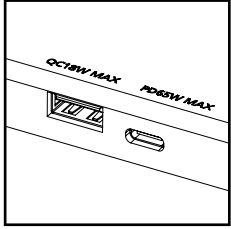

Neptune is fitted with integral USB type-A (18W max) and type-C (65W max) chargers.

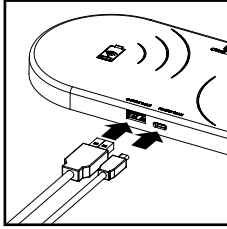

Insert type-A and type-C USB cables into their respective ports as shown.

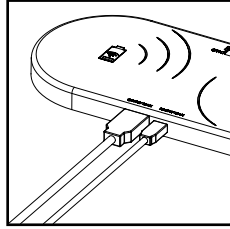

Ensure cables are securely connected.

## Wireless charging

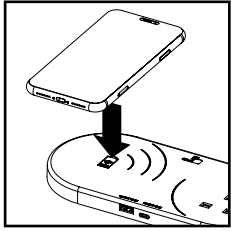

Place a compatible device as shown onto the area marked with a battery icon.

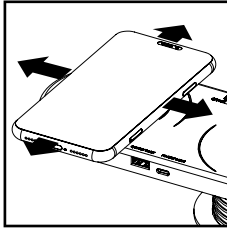

You may need to adjust your compatible device to align the charging elements.

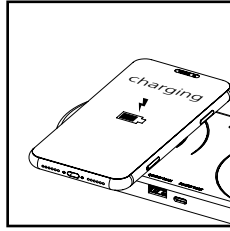

The compatible device should indicate that charging has initiated when correctly placed.

## Resetting the circuit breaker

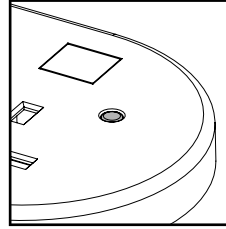

Neptune is fitted with an integral circuit breaker

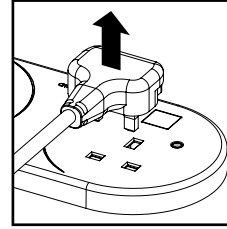

In the event of the circuit breaker tripping, remove the connected plug first.

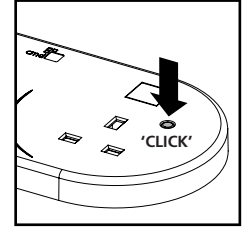

Using an appropriate tool, fully depress the reset button until a click is heard.

## Additional information

### Safety

- Installation is to be carried out in accordance with relevant Health & Safety regulations and only to be carried out by a skilled or competent person.
- The product should be installed to comply with the relevant national standards and be inspected and tested prior to being put into service (in the UK BS 7671 Wiring Regulations or BS 6396 Office and Educational Systems Best Practice).
- Isolate the supply before installation or repositioning. Any locking mechanisms must be used and fully engaged.
- Incorrect use could lead to risk of electrocution.
- Connectors must not be engaged or disengaged when under load or live.
- Product to be used only for the intended purpose of distributing power and data in office and commercial environments.
- Do not misuse, dismantle or re-configure the product because doing so will invalidate the warranty.

### Standards

- Refer to the Declaration of Conformity.

### Further guidance

- Compatible wireless charged devices (i.e mobile telephones) may require protective cases removing to allow the wireless charger to function correctly. Consult the operation manual of your compatible device for further information.
- Should the supply cable need replacing, contact CMD.

### Product care

- Clean using a dry cloth. No abrasives or solvents to be used on the product.
- Do not drop or expose to moisture.

